

**WATER SERVICE TAP PLAN VIEW**

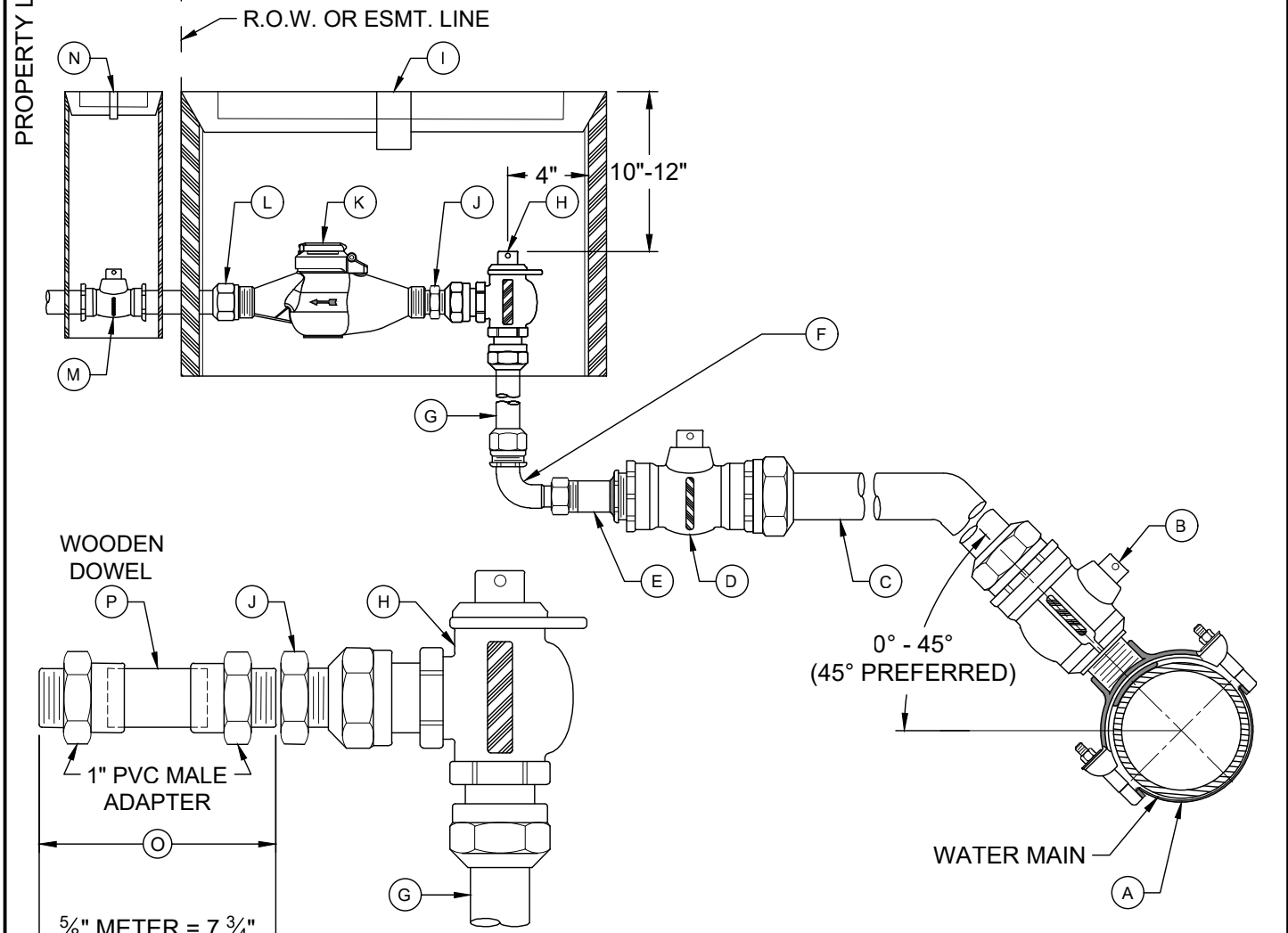

**WATER SERVICE TAP PROFILE VIEW**

$\frac{5}{8}$ " METER = 7  $\frac{3}{4}$ "  
 $\frac{3}{4}$ " METER = 9"  
 1" METER = 11"

<p>CITY OF AUSTIN AUSTIN WATER</p>	<p>WATER SERVICE &amp; METER INSTALLATION - 1" &amp; SMALLER METERS</p>	<p>STANDARD NO. <b>520-AW-01B</b></p>
<p><i>JEFF A. KYLE</i></p>	<p><i>08/16/2019</i> ADOPTED</p>	<p>THE ARCHITECT/ENGINEER ASSUMES RESPONSIBILITY FOR APPROPRIATE USE OF THIS STANDARD.</p>
		<p>1 OF 2</p>

**MATERIALS LIST:**

- A. 2" SERVICE CLAMP, SPL WW-264
- B. 2" CORPORATION STOP, SPL WW-68
- C. 2" HDPE WATER SERVICE TUBING, SPL WW-65
- D. 2" BALL VALVE, SPL WW-68
- E. SINGLE SERVICE: 2" MIP X 1" COPPER FLARE FITTING, SPL WW-68 OR  
DOUBLE SERVICE: 2" MIP X 1" COPPER FLARE WYE, SPL WW-68
- F. 1" SWIVEL NUT x 1" COMPRESSION 90° BEND, SPL WW-68
- G. 1" HDPE WATER SERVICE TUBING, SPL WW-65
- H. 1" ANGLE METER STOP, SPL WW-68
- I. METER BOX AND LID, SPL WW-145A;  
FOR DUAL 1" METERS: USE TWO SINGLE METER BOXES

**MATERIALS TO BE INSTALLED BY PLUMBER:**

- J. BRASS METER BUSHING - SIZE AS NEEDED TO CONNECT ANGLE METER STOP TO METER
- K. WATER METER PURCHASED FROM AUSTIN WATER
- L. BRASS WATER METER COUPLING MALE IPT x SWIVEL COUPLING NUT:  
5/8" AND 3/4" METERS: 8 1/2" LONG x 3/4" DIA.  
1" METERS: 8 1/2" LONG x 1" DIA.
- M. PROPERTY OWNER'S CUT OFF VALVE, SPL WW-276
- N. PROPERTY OWNER'S CUT OFF VALVE BOX AND LID
- O. TEMPORARY METER SPACER (REQUIRED TO ASSURE METER WILL FIT APPROPRIATELY)
- P. 1" WOODEN DOWEL (SHOW ADDRESS ON DOWEL USING WATERPROOF MARKER)

**NOTES:**

1. SERVICE CLAMP SHALL BE WRAPPED COMPLETELY WITH 8 MIL. POLYETHYLENE FILM, SPL WW-27D.
2. BRANCH CONNECTIONS AND ALL ANGLE METER STOPS MUST BE INSTALLED PRIOR TO ANY METER INSTALLATION.
3. TOP OF METER BOXES SHOULD BE 4" ABOVE GROUND.
4. PIPING AND TUBING IN STREET RIGHT-OF-WAY SHALL BE BEDDED IN GRANULAR MATERIALS AS REQUIRED BY SECTION 510.3 (14) OF THE CITY OF AUSTIN STANDARD SPECIFICATIONS; BACKFILL ABOVE GRANULAR BEDDING AS REQUIRED BY SECTION 510.3 (25).
5. METER BOX MUST BE BEHIND CURB NEXT TO PROPERTY LINE OR EASEMENT AND OUT OF VEHICULAR TRAFFIC AREA AND SIDEWALK.
6. BALL VALVE "D" SHALL NOT BE LOCATED UNDER SIDEWALK, CURB, OR PAVEMENT, AND NOT BE LOCATED MORE THAN 36" BELOW FINAL GRADE.
7. METER SIZES TO BE SHOWN ON PLANS.
8. METER BOX CUT OUTS SHALL NOT EXCEED TWO TIMES THE PIPE DIAMETER.
9. INSTALL METALLIC TRACER TAPE, SPL WW-597, MINIMUM 1' ABOVE TUBING FROM SERVICE CLAMP "A" TO BALL VALVE "D".
10. TUBING SHALL BE PLACED IN A STRAIGHT ALIGNMENT AND ALLOWED TO RELAX AND "SNAKE" LOOSELY IN THE TRENCH. TUBING BEHIND CURB AND GUTTER SHALL BE INSTALLED WITH A MINIMUM 2' DEPTH OF COVER.
11. 1" TUBING, WHEN BENT, SHALL HAVE A RADIUS NO SMALLER THAN 3'. 2" TUBING, WHEN BENT, SHALL HAVE A RADIUS NO SMALLER THAN 5'. BRASS FITTINGS SHALL NOT BE CONNECTED TO A BENT SECTION OF TUBING.
12. SOLID, TUBULAR STAINLESS STEEL INSERT STIFFENERS FOR HDPE TUBING SHALL BE USED AT ALL COMPRESSION FITTINGS. INSERT STIFFENERS SHALL BE FROM THE SAME MANUFACTURER AS THE COMPRESSION FITTING USED.
13. FOR RECLAIMED WATER SERVICES AND METERS, ALL RECLAIMED TUBING SHALL BE MANUFACTURED SOLID PURPLE, SPL WW-65A. ALL APPURTENANCES SHALL BE MANUFACTURED PURPLE IF AVAILABLE. ALL FITTINGS THAT ARE NOT AVAILABLE FROM THE MANUFACTURER IN PURPLE SHALL BE PAINTED PURPLE PER SPL WW-3C. ALL METER BOX LIDS SHALL BE PURPLE AND HAVE **"RECLAIMED WATER"** CAST INTO THEM, SPL WW-145A.

CITY OF AUSTIN AUSTIN WATER		WATER SERVICE & METER INSTALLATION - 1" & SMALLER METERS	
<u>JEFF A. KYLE</u>	<u>08/16/2019</u> ADOPTED	THE ARCHITECT/ENGINEER ASSUMES RESPONSIBILITY FOR APPROPRIATE USE OF THIS STANDARD.	STANDARD NO. <b>520-AW-01B</b> 2 OF 2